

Quick start guide

CO₂ Laser Cutting Machine

SIL Laser Cutting & Engraving Machine

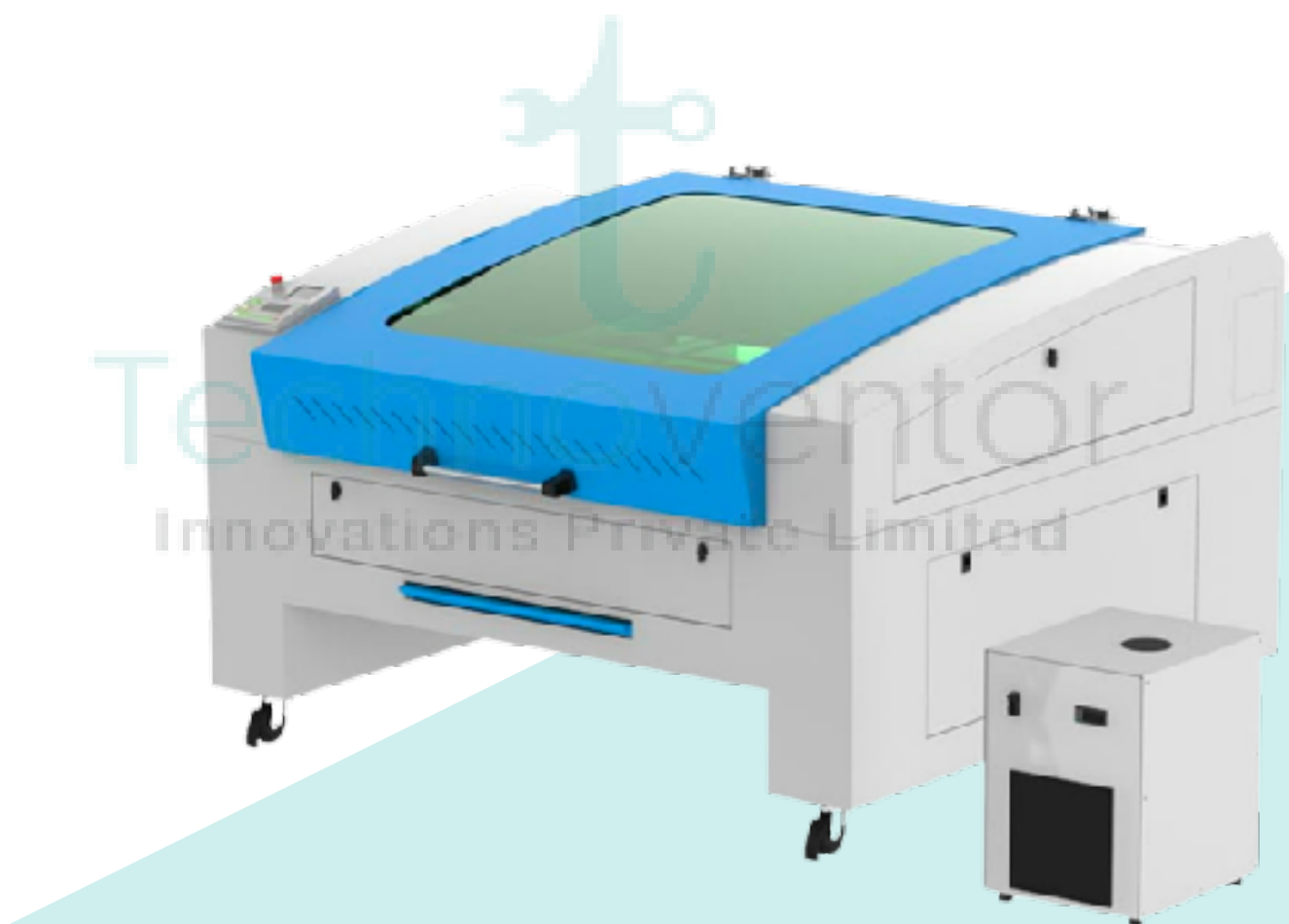

Scan to Download the Software

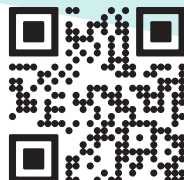

Machine Appearance & Accessories



Operation of Laser Beam

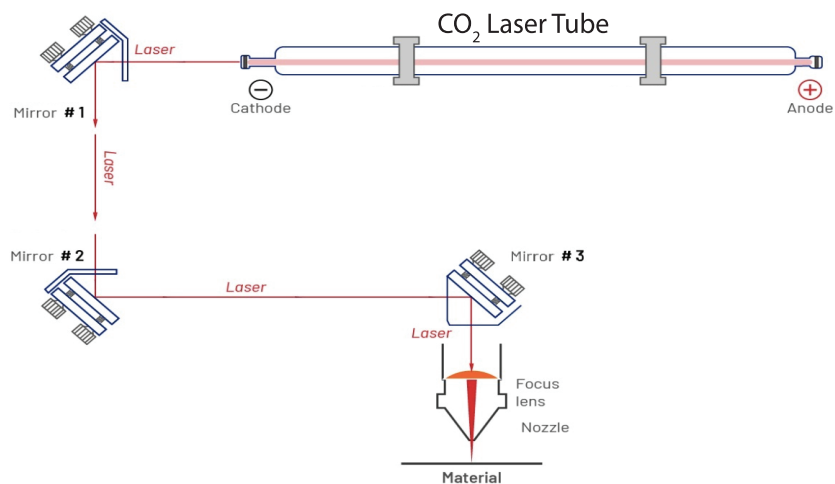

Machine Startup & Testing

1

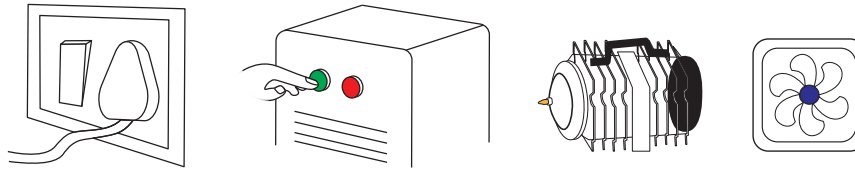

Switch ON the main switch, Laser Machine, Chiller Unit, Air compressor and Exhaust Fan.

2

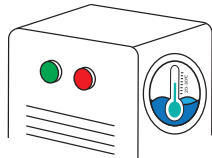

In a chiller unit, Check the temperature of a cooling water between 20-30°C.

3



Check air is blowing from a nozzle.

4

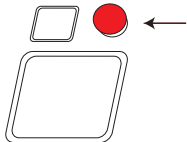

Pull emergency switch on to turn on Control Panel.

5



Check lenses and mirrors are clean.

6

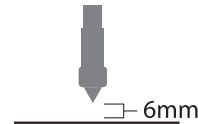

Maintain 6mm gap in between cutting material and nozzle.

Operation

Technoventor
Innovations Private Limited

Select file from
local drive for
cutting/engraving.

Close machine
door & Press
Start Button.

Set the origin and
Press Box button ensure
cutting frame is properly
covering the media.

After cutting operation,
remove cut object from
machine and switch off.

1

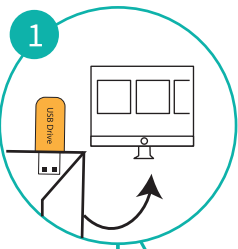

Connect USB drive
to machine and
select copy file to
local drive.

2

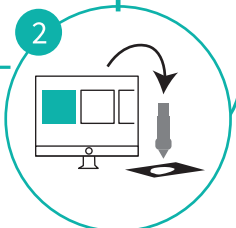

3

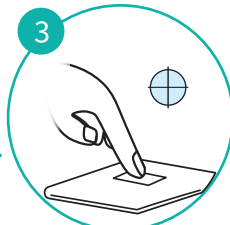

4

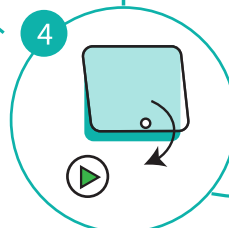

5

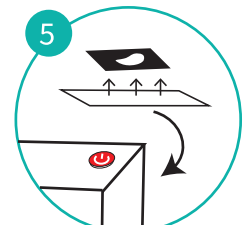

DO's

- ✓ Clean Cutting bed, nozzle, and guide way of a machine regularly for smooth operations
- ✓ X-Y axis belts must be tight.
- ✓ Check water level in a chiller unit and replace it periodically.
- ✓ Keep your machine in clean dust free environment with humidity below 80% non-condensing.
- ✓ Provide adequate exhaust duct to remove fume from the area where machine is kept.
- ✓ While performing maintenance always switch off the machine.

DONT's

- ✗ Do not open the machine door while operation is going on.
- ✗ Don't run the machine without air in nozzle as might damage lens.
- ✗ Don't run the machine unattended it. Your process may catch fire and can lead to fire.
- ✗ Do not operate machine without UPS.
- ✗ Do not use any other power cables except provided with machines.
- ✗ Do not observe laser beam naked eye.
- ✗ Do not run the machine if there is an abnormal sound.

Machine Specifications

SPECS/MODEL	AccuCut 1212 / AccuCut 6090
Working Area	1200x1200mm / 600x900mm
Laser Type	Co2 DC Glass Laser Tube
Laser Power Option	Glass Tube – 60/80/100/130/150 Watt
Wave Length	10.6 μ m
Supply Voltage	AC 230 V \pm 0.05% / AC 415 V \pm 0.05%
Reposition Accuracy	0.1 mm (Max)
Cutting Speed / Engraving Speed	0 ~ 300 mm/min
Cooling	Water Cooled
Graphic File Support	PLT, CDR, AI, DWG, DST, DXF, BMP, JPEG, TIFF, GIF, PCX

For any queries contact:

✉ service@technoventor.com

☎ 8828294964 / 7304419928